

Priority Valve #VL-530141-TG

The roles of a priority valve (a.k.a. back pressure valve or pressure maintaining valve) are numerous but it's typically employed to maintain constant pressure on the filter system thereby increasing efficiency of the purification process - as much as 400%!

The L-Factor priority valve is designed to withstand harsh environments & brutal usage. All internal areas are built of corrosion resistant materials including stainless steel & hard-coat aluminum. The most outstanding feature is an *internal check valve* saving you the expense & trouble of installing one separately. The inlet fitting, also stainless steel, comes standard with 1/4" npt-male thread but can be easily swapped for Boss or Metric versions. Three (3) discharge ports conveniently add a manifold function to this valve, as well. Includes instructions, pre-taped pipe thread inlet, locking nut, safety wire, & our unparalleled "Critical Factor" warranty.

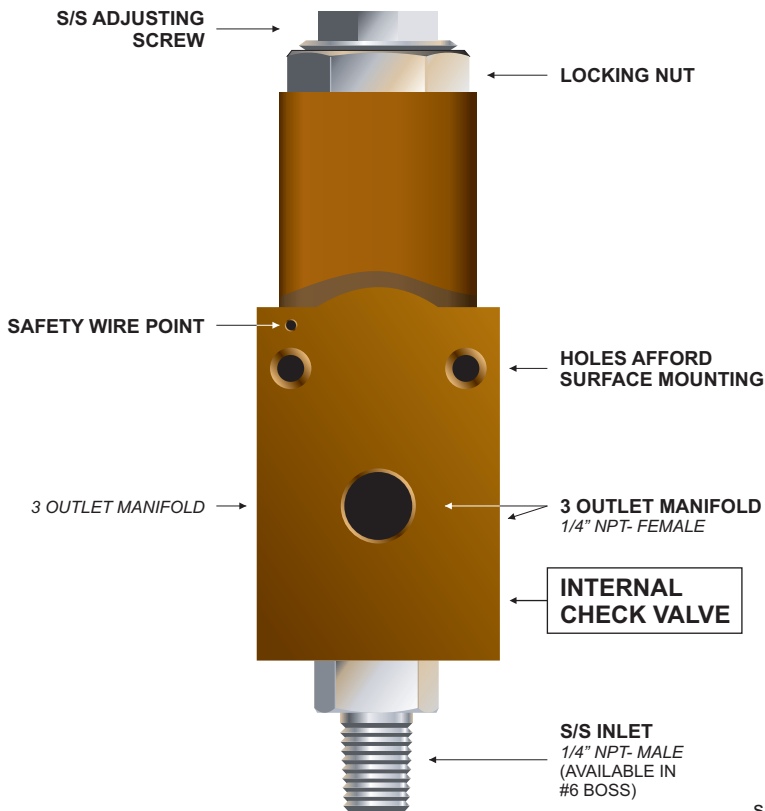

SPECIFICATIONS	
MAXIMUM PSI:	7000 PSI
ADJUSTABLE PSI:	1000 - 7000 PSI
FLOW CAPACITY:	75 SCFM
INLET:	1/4" NPT MALE (stainless steel)
OUTLET:	1/4" NPT FEMALE (3 ports)
SURFACE MOUNT:	Two #8 HOLES
OVERALL DIMS:	5 1/2" Tall x 1 1/2" Square

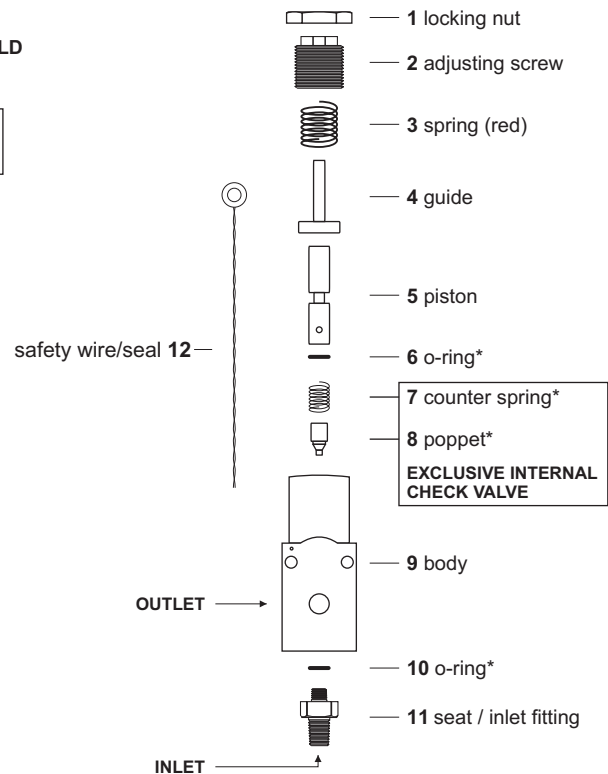

"CRITICAL FACTOR" PROMISE

We put our heart and soul into our products. We invite you to take a step up to L-Factor. Like taking a step back in time when a promise was gold - you'll be satisfied - and that's our promise!

When used in proper application and according to our instructions, L-Factor warrants this product to be free from defects in material and workmanship for a period of 12 months. Refer to the complete warranty information for details. Step up to an L-Factor product.

Old fashioned craftsmanship, new fashioned technology, working together to produce Genuine L-Factor products.

*Included in Service Kit #RK-530210-HS



4740 NW 157 Street, Miami Lakes, FL 33014 Phone: (305) 430-0550 Fax: (305) 430-0864
email: L-factor@ix.netcom.com web page: www.lawrence-factor.com

L-Factor is a trademark; Lawrence Factor, X-pendable, and X-zam are registered trademarks of Lawrence Factor, Incorporated. All other Logos/Trade Names depicted in this cut-sheet are the property of their respective owners.