

Relief Valve #VL-530130-TH

A product so reliable yet so fairly priced that it is destined to rise above other industry favorites. This pressure relief valve has proven itself dependable, stout, resistant to harsh environments, easy to maintain, and well designed. Testing and practical use has shown that it can withstand thousands of cycles without leaking-by or drifting. The body is constructed of high tensile, hard coated aluminum while all whetted areas are corrosion resistant materials such as stainless steel or plastic resin. The inlet fitting, also stainless steel, comes standard with 1/4" npt-male threads but can be easily swapped for Boss or Metric versions. Plenty of attention has been paid to details such as polished edges, pre-taped pipe thread, inclusion of safety wire, instruction manual and our unparalleled 12-month "Critical Factor" warranty.

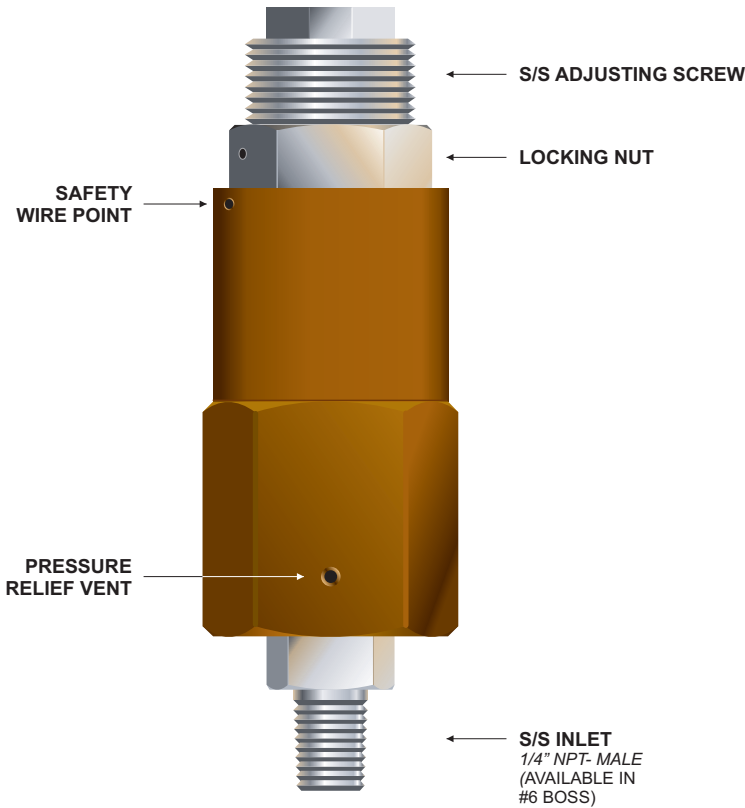

SPECIFICATIONS	
MAXIMUM PSI:	5000 PSI
ADJUSTABLE PSI:	1000 - 5000 PSI
BURST PSI:	28,000 PSI
CYCLE LIFE:	500,000
SAFETY FACTOR:	4:1
FLOW CAPACITY:	50 SCFM
INLET:	1/4" NPT Male Stainless Steel (303)
OPT CONNECTION:	#6 BOSS Male
BODY MATERIAL:	Aluminum (6061T6) w/ Hard Coat Anodize
OVERALL DIMS:	4" Tall X 1 1/2" Hexagonal

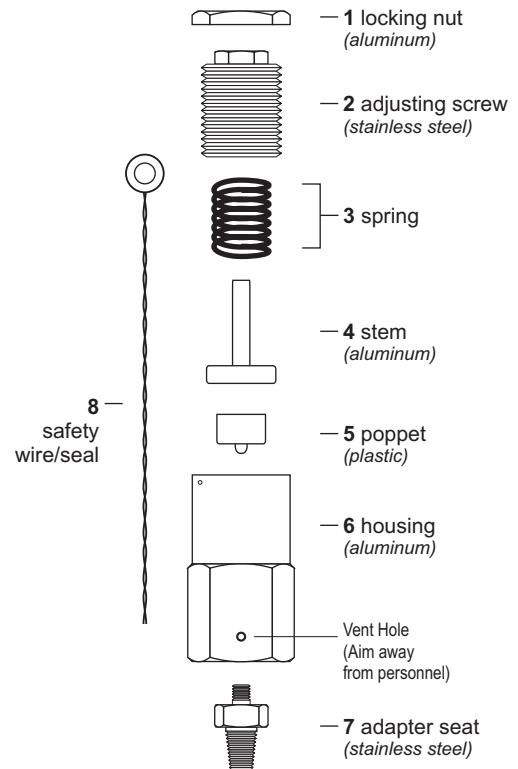

"CRITICAL FACTOR" PROMISE

We put our heart and soul into our products. We invite you to take a step up to L-Factor. Like taking a step back in time when a promise was gold - you'll be satisfied - and that's our promise!

When used in proper application and according to our instructions, L-Factor warrants this product to be free from defects in material and workmanship for a period of 12 months. Refer to the complete warranty information for details. Step up to an L-Factor product.

Old fashioned craftsmanship, new fashioned technology, working together to produce Genuine L-Factor products.



4740 NW 157 Street, Miami Lakes, FL 33014 Phone: (305) 430-0550 Fax: (305) 430-0864
email: L-factor@ix.netcom.com web page: www.lawrence-factor.com

L-Factor is a trademark; Lawrence Factor, X-pendable, and X-zam are registered trademarks of Lawrence Factor, Incorporated. All other Logos/Trade Names depicted in this cut-sheet are the property of their respective owners.